

# BACKER IMMERSION HEATERS FOR WATER HEATING WITH ELEMENT TUBES IN COPPER



## Properties

Backer standard range of screw plug immersion/ insertion heaters in stock are suitable as heat sources for instance in domestic water heaters, calorifiers, electric boilers, tanks and industrial baths.

The heaters consists of 3 pieces Backer tubular heating elements soldered to a screw plug. It could be fitted with different accessories such as terminal box, thermostat, safety temperature limiter, tube and insulation for flow-through heater and socket key for assembly.

## Technical specification

Material	Tubular elements Ø8,5 mm in copper C 12200 Screw plug G2" (R50, 60 mm) in brass Tube for thermostat/ temp.limiter Ø12x0,7 length 187 mm in copper IU 31-33 Tube Ø12x0,7 length 260 mm in copper IU 34-315
Inactive length	60±6 mm
Electric connection	M4
Assembly	Kit with gasket and connection parts included
Max working temperature	120°C
Max working pressure	9 bar
Manufacturing standard	Backer 40579311 CE
Standards	SS 4330701, SS-EN 60335-1, UL-1030, ISO 6469-3
Power tolerance	+5% / -10%
Surface power density	Approx 8 W/cm <sup>2</sup>

## Standard assortment

Type IU	Power W	Voltage V	Insertion length Max mm	Article no
IU31	1500	230/400	180	2520341001
IU33	2250	230/400	230	2520341002
IU34	3000	230/400	280	2520341003
IU36	4500	230/400	390	2520341005
IU39	6000	230/400	390	2520341007
IU310	7500	230/400	390	2520341008
IU311	9000	230/400	390	2520341009
IU312	10500	230/400	880	2520341010
IU313	12000	230/400	1005	2520341011
IU314	13500	230/400	1110	2520341012
IU315	15000	3x400	1260	2520341013

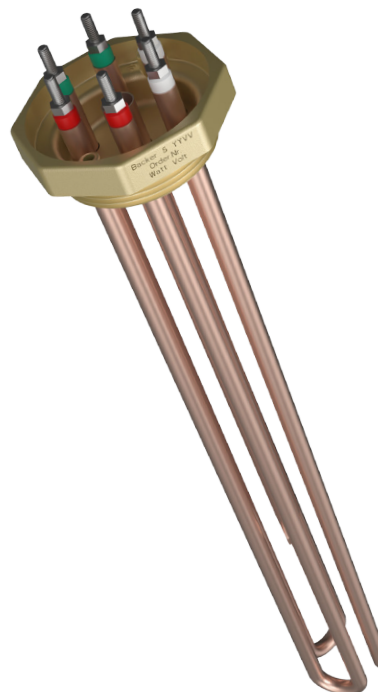

Type IU31-36, IU312-315



Type IU39-311

# BACKER IMMERSION HEATERS FOR WATER HEATING WITH ELEMENT TUBES IN COPPER



Type IU31-36, IU312-315

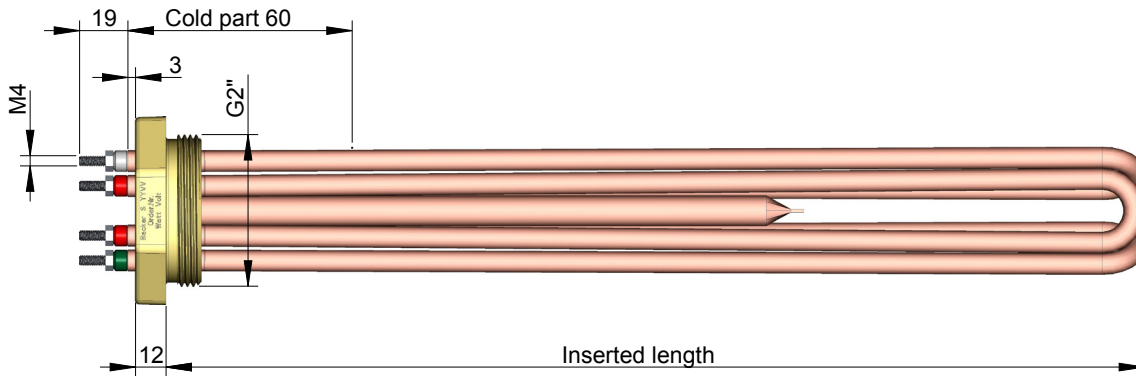

Type IU39-311

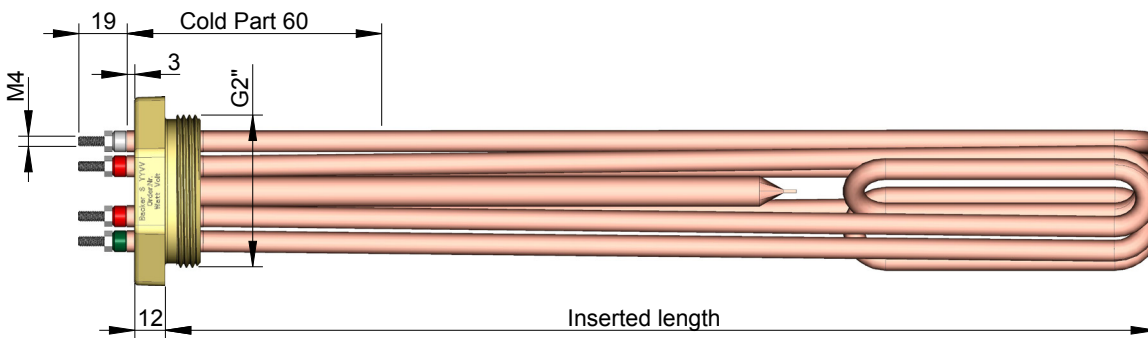

## Circuit diagram/ connection alternatives\*

IU31-314

IU315

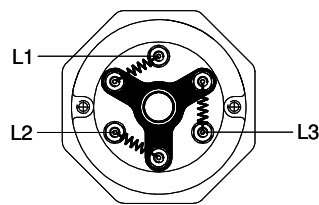
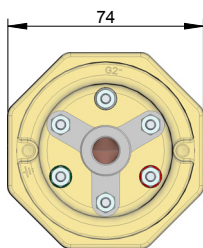

Star connection Y 3x400V

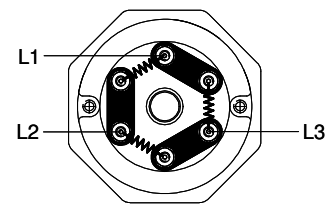
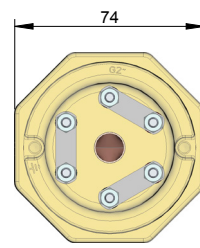

Delta connection D 3x400V

\*Electric connection must be performed by an appropriated electrician

## Options

Terminal boxes, thermostats and temperature safety limiters, different options

Tube and insulation for flow-through heater, different options

Socket key G2" article no 1160143201

Nut G2" in brass article no 1140485405